



Agricultural Concrete Solutions Datasheet

READYMIX FARMPAVE

With CEMEX Readymix you can be assured of getting the best range of agricultural concrete solutions, specifically designed to high specifications for various end uses meeting the requirements of modern farming.

Readymix Farmpave is a high strength, durable concrete for use on external paved areas subjected to the constant loading and scraping imposed by farm vehicles and machinery. It is also designed to resist damage from frost and the aggressive conditions found in an agricultural environment. Readymix Farmpave reflects the growing emphasis on statutory regulation and farm assurance schemes and makes selection of the appropriate product simple, yet effective.

Applications

- Yards and aprons
- Roadways
- Loading bays
- Pathways

Features and Benefits

- High strength withstanding heavy trafficking
- Durable and highly resistant to freeze/thaw damage and excessive weathering
- High quality cleanable surface finish, increasing paving asset value
- Surface can be textured for increased slip resistance
- Can be formed in order to assist drainage and surface water control
- Meets or exceeds the relevant British and European Standards

Adding Fibres – Additional Features and Benefits

By adding polypropylene fibres to Readymix Farmpave you will enhance the concrete mix and obtain the following additional features and benefits:

- Reduced plastic cracking
- No need for crack control wire mesh
- Impact and abrasion resistant
- Enhanced surface finish
- Enhanced durability from increased farm machinery trafficking



CEMEX UK Materials Ltd

National Technical Centre, The Old Cement Works,
Long Itchington, Southam, Warwickshire CV47 9RA.
Tel: 01926 812671

Delivery

The standard CEMEX Readymix truck mixer is ideal for straightforward deliveries to site, although unloading may take up to 40 minutes. Where access or ground conditions may be a problem, contact your local sales office in advance.

CEMEX Readymix also offers a range of flexible options for concrete delivery. These include specialist Minimix and small loads services, these are a cost effective means of placing small volumes of concrete, ideal for home building, extension and renovation work, or where site access is difficult.

A sales directory service and estimating guide are available on our website www.cemex.co.uk

Health and safety

Contact with concrete may cause irritation, dermatitis or severe alkali burns. There is serious risk of damage to the eyes. Wear suitable waterproof protective clothing, gloves and eye/face protection. In case of contact with eyes, rinse immediately with plenty of clean water and seek medical advice. After contact with skin, wash immediately with plenty of clean water. Keep out of reach of children. Contains Chromium (VI), may cause allergic reaction.

For a detailed datasheet please visit the health & safety section of our website www.cemex.co.uk

Sustainability Commitment

As a company CEMEX UK embraces the challenges of sustainable development, in striving to be socially, economically and environmentally responsible in everything we do to safeguard the needs of future generations, CEMEX Readymix use efficient automated batching systems reducing waste water discharge, other similar systems are in place for stone washing and aggregate reclaim and finally during production operations water is extracted and recycled at many of the plants. the following are just a few other examples:

Reducing CO₂ emissions and need for landfill through investment in new handling equipment for trials of Climafuel, a sustainable fuel which can replace fossil fuels by up to 30%.

Reducing road congestion through initiatives like 'Road Load', ensuring over 95% of lorries are at payload before travel, and '24/7 Load', allowing non-urgent material to be delivered out-of-hours.

Reusing material which would otherwise go to landfill through development of blended cements incorporating by-products from other industries.

Regenerating and restoring land across the UK to provide lasting benefit to local communities and diverse habitats for wildlife.

CEMEX UK Materials Ltd

National Technical Centre, The Old Cement Works,
Long Itchington, Southam, Warwickshire CV47 9RA.
Tel: 01926 812671

Advice

Increasingly, within quality assurance systems, external yards are viewed as important as the production facility or the enterprise itself with reference to roads and yards being specified in QA standards i.e. Milk and Dairy Regulations, National Dairy Assurance. In order to ensure that the concrete not only passes inspection but is also durable and strong, it is essential to place and cure properly.

Pre-construction

Prior to beginning the project it is important to carry out some standard checks and measures.

- Check for lorry access, although CEMEX Readymix has alternative delivery options designed to allow access to difficult to reach areas
- Assess the ground conditions noting made up or soft ground
- Ensure adequate labour and equipment resources are provided to place, compact and finish the concrete
- Ensure that the sub-base and forms are properly prepared (poorly compacted subbase or poorly fixed forms often result in concrete failure)
- Plan ahead for extreme temperature, both high and low, since this can seriously affect the final strength of the concrete. In low temperature cover with an insulating material and in high temperatures cover with polythene and spray with water

Typical paving joint detail – contraction joint

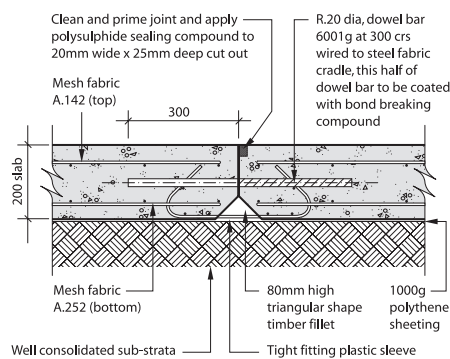

Base Works

Excavate and fill with graded granular material compacted and raised in 225mm lifts up to sub-base level. For the sub-base lay graded granular material blinded with a thin layer of sand and compacted with a vibrating roller.

Reinforcement

If polypropylene fibres are added this will eliminate the need to provide crack control steel reinforcement (top steel).

Finishing

Texture the concrete to provide a finished surface. A heavy brush or tamped finish is the most common. You will also need to backfill the edges of the concrete with sub-base material to avoid cracking of the edge and to ensure that the rain can run-off the low side of the concreted area.

Post construction

Check periodically for deterioration of joints and replace jointing material if required. Failure to seal the joints will result in the onset of the freeze/thaw process in the joint.

FAQ's

Q. What makes Readymix Farmpave better than normal mixes?

A. Readymix Farmpave is a specially designed mix for the agricultural industry and takes into account the anticipated traffic and varied climatic conditions in and around the farm.

Q. Can I get a milk tanker in within 24 hours of placing?

A. Early trafficking by heavy vehicles will damage the new surface and may also cause serious cracking. Ideally, the concrete should not be subjected to vehicular use for seven days without protecting the surface. We can provide guidance where this is not possible.

Q. Does the slab need steel reinforcement?

A. Unless the sub-base is unstable or weak, steel reinforcement will not be required. Farmpave can contain polypropylene fibres to control plastic shrinkage cracking. We can advise on movement joint location and spacing.

Q. What type of surface finish do you recommend?

A. For vehicular traffic we would advise a normal tamped finish but where livestock movement is anticipated then a heavy brush finish would be more appropriate.

Q. Is Readymix Farmpave readily available?

A. Yes, it can be supplied from all our depots without any additional prior notice.